

ACI Central Inc.

20 McAulay Court, Charlottetown, PE C1A 9M7
P.O. Box 53, Charlottetown, PE C1A 7K1. Phone: 902-566-1975, Fax: 902-566-3133

Recommendation to Register – Pressure Vessel Design

To: Steve Townsend

Date: 01/24/2022

From: ACI Central Inc.

Manufacturer: Kennedy Fabricating LLC
13436 Kennedy Dr
Splendora, TX 77372
USA

Manufacturer #: PV-9883

Subject: ACI Central Design Review

The product described on this form has satisfied the requirements for review of pressure vessel designs established by the Directors of ACI Central at their September 1994 meeting in Moncton, New Brunswick. We recommend this design be registered in your Jurisdiction under;

CRN: Z4814.2

Unit Description	Drawing Number	Service	Design Code
Knockout Drum	526-01-CRN rev 0	Non Lethal	ASME Sect VIII Div. 1

Shell Side

Tube Side

MAWP @ TEMP	MDMT @ MAWP	MAWP @ TEMP	MDMT @ MAWP
150 PSI @ 450 F	- 20 F @ 150 PSI		

Test Pressure: Hydro: 195 PSI	Pneu:	Test Pressure: Hydro:	Pneu:
-------------------------------	-------	-----------------------	-------

Part	Material	Des. t"	Act. t"	CA"	% EF	RT	PWHT	Dimensions	Notes
Shell	SA 516 70	0.488	0.500	0.125	85	RT3		OD": 80" ID	
Heads	SA 516 70	0.485	0.500	0.125	85			OAL": 284.5"	
Nozzles	SA 106 B							W":	
Flanges	SA 105N							H":	
								HS FT²:	

Notes:

- 1- The return of this form, bearing the signature and stamp of the Jurisdiction will legally establish the CRN shown on this form.
- 2- A copy of the Design bearing the CRN will be sent to the Manufacturer.
- 3- Details including service conditions will be posted on the 'Silent Inspector' Bulletin Board.
- 4- Copies of the Design and Specifications are available to ACIC Members on demand.
- 5- The form will be a permanent ACIC record.
- 6- To reduce turnaround times to a minimum fax your response to 902-566-3133.

ACIC Log#: 32210

Description: Knockout Drum, 80" ID
ASME Stamp, National Board Registered

This space is for Jurisdictional stamp and signature

ACCEPTED
PROVINCE OF PRINCE EDWARD ISLAND
COMMUNITY, LAND & ENVIRONMENT
C.A.R. Z4814.29
DATE: JAN 28/22
INSPECTION SERVICES SECTION
BOILER/PRESSURE VESSEL BRANCH

ACI Central Inc.

20 McAulay Court, Charlottetown, PE C1A 9M7
P.O. Box 53, Charlottetown, PE C1A 7K1. Phone: 902-566-1975, Fax: 902-566-3133

Recommendation to Register – Pressure Vessel Design

To: Donnie Ehler

Date: 01/24/2022

From: ACI Central Inc.

Manufacturer: Kennedy Fabricating LLC
13436 Kennedy Dr
Splendora, TX 77372
USA

Manufacturer #: PV-9883

Subject: ACI Central Design Review

The product described on this form has satisfied the requirements for review of pressure vessel designs established by the Directors of ACI Central at their September 1994 meeting in Moncton, New Brunswick. We recommend this design be registered in your Jurisdiction under;

CRN: Z4814.2

Unit Description	Drawing Number	Service	Design Code
Knockout Drum	526-01-CRN rev 0	Non Lethal	ASME Sect VIII Div. 1

Shell Side

Tube Side

MAWP @ TEMP	MDMT @ MAWP	MAWP @ TEMP	MDMT @ MAWP
150 PSI @ 450 F	- 20 F @ 150 PSI		

Test Pressure: Hydro: 195 PSI	Pneu:	Test Pressure: Hydro:	Pneu:
-------------------------------	-------	-----------------------	-------

Part	Material	Des. t"	Act. t"	CA"	% EF	RT	PWHT	Dimensions	Notes
Shell	SA 516 70	0.488	0.500	0.125	85	RT3		OD": 80" ID	
Heads	SA 516 70	0.485	0.500	0.125	85			OAL": 284.5"	
Nozzles	SA 106 B							W":	
Flanges	SA 105N							H":	
								HS FT²:	

Notes:

- 1- The return of this form, bearing the signature and stamp of the Jurisdiction will legally establish the CRN shown on this form.
- 2- A copy of the Design bearing the CRN will be sent to the Manufacturer.
- 3- Details including service conditions will be posted on the 'Silent Inspector' Bulletin Board.
- 4- Copies of the Design and Specifications are available to ACIC Members on demand.
- 5- The form will be a permanent ACIC record.
- 6- To reduce turnaround times to a minimum fax your response to 902-566-3133.

ACIC Log#: 32210

Description: Knockout Drum, 80" ID
ASME Stamp, National Board Registered

This space is for Jurisdictional stamp and signature

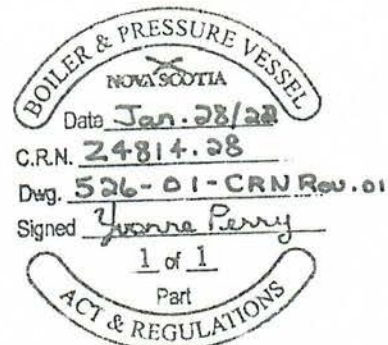

ACI Central Inc.

20 McAulay Court, Charlottetown, PE C1A 9M7
P.O. Box 53, Charlottetown, PE C1A 7K1. Phone: 902-566-1975, Fax: 902-566-3133

Recommendation to Register – Pressure Vessel Design

To: Eben Creaser

Date: 01/24/2022

From: ACI Central Inc.

Manufacturer: Kennedy Fabricating LLC
13436 Kennedy Dr
Splendora, TX 77372
USA

Manufacturer #: PV-9883

Subject: ACI Central Design Review

The product described on this form has satisfied the requirements for review of pressure vessel designs established by the Directors of ACI Central at their September 1994 meeting in Moncton, New Brunswick. We recommend this design be registered in your Jurisdiction under;

CRN: Z4814.2

Unit Description	Drawing Number	Service	Design Code
Knockout Drum	526-01-CRN rev 0	Non Lethal	ASME Sect VIII Div. 1

Shell Side

Tube Side

MAWP @ TEMP	MDMT @ MAWP	MAWP @ TEMP	MDMT @ MAWP
150 PSI @ 450 F	- 20 F @ 150 PSI		

Test Pressure: Hydro: 195 PSI	Pneu:	Test Pressure: Hydro:	Pneu:
-------------------------------	-------	-----------------------	-------

Part	Material	Des. t"	Act. t"	CA"	% EF	RT	PWHT	Dimensions	Notes
Shell	SA 516 70	0.488	0.500	0.125	85	RT3		OD": 80" ID	
Heads	SA 516 70	0.485	0.500	0.125	85			OAL": 284.5"	
Nozzles	SA 106 B							W":	
Flanges	SA 105N							H":	
								HS FT²:	

Notes:

- 1- The return of this form, bearing the signature and stamp of the Jurisdiction will legally establish the CRN shown on this form.
- 2- A copy of the Design bearing the CRN will be sent to the Manufacturer.
- 3- Details including service conditions will be posted on the 'Silent Inspector' Bulletin Board.
- 4- Copies of the Design and Specifications are available to ACIC Members on demand.
- 5- The form will be a permanent ACIC record.
- 6- To reduce turnaround times to a minimum fax your response to 902-566-3133.

ACIC Log#: 32210

Description: Knockout Drum, 80" ID
ASME Stamp, National Board Registered

This space is for Jurisdictional stamp and signature

New Brunswick
DEPT OF JUSTICE PUBLIC SAFETY
BOILER & PRESSURE VESSEL ACT

REGISTRATION ONLY

CRN Z4814.27

Ran Arnes
CHIEF BOILER INSPECTOR

DATE 1/28/22

☐ BLRs ☒ PVs

☐ FITTINGS ☐ NUCLEAR COMPONENTS

See Form 100 Rev. 1 06/2003

ACI Central Inc.

20 McAulay Court, Charlottetown, PE C1A 9M7
P.O. Box 53, Charlottetown, PE C1A 7K1. Phone: 902-566-1975, Fax: 902-566-3133

Recommendation to Register – Pressure Vessel Design

To: Stephen Higdon

Date: 01/24/2022

From: ACI Central Inc.

Manufacturer: Kennedy Fabricating LLC
13436 Kennedy Dr
Splendora, TX 77372
USA

Manufacturer #: PV-9883

Subject: ACI Central Design Review

The product described on this form has satisfied the requirements for review of pressure vessel designs established by the Directors of ACI Central at their September 1994 meeting in Moncton, New Brunswick. We recommend this design be registered in your Jurisdiction under;

CRN: Z4814.2

Unit Description	Drawing Number	Service	Design Code
Knockout Drum	526-01-CRN rev 0	Non Lethal	ASME Sect VIII Div. 1

Shell Side

Tube Side

MAWP @ TEMP	MDMT @ MAWP	MAWP @ TEMP	MDMT @ MAWP
150 PSI @ 450 F	- 20 F @ 150 PSI		

Test Pressure: Hydro: 195 PSI	Pneu:	Test Pressure: Hydro:	Pneu:
-------------------------------	-------	-----------------------	-------

Part	Material	Des. t"	Act. t"	CA"	% EF	RT	PWHT	Dimensions	Notes
Shell	SA 516 70	0.488	0.500	0.125	85	RT3		OD": 80" ID	
Heads	SA 516 70	0.485	0.500	0.125	85			OAL": 284.5"	
Nozzles	SA 106 B							W":	
Flanges	SA 105N							H":	
								HS FT²:	

Notes:

- 1- The return of this form, bearing the signature and stamp of the Jurisdiction will legally establish the CRN shown on this form.
- 2- A copy of the Design bearing the CRN will be sent to the Manufacturer.
- 3- Details including service conditions will be posted on the 'Silent Inspector' Bulletin Board.
- 4- Copies of the Design and Specifications are available to ACIC Members on demand.
- 5- The form will be a permanent ACIC record.
- 6- To reduce turnaround times to a minimum fax your response to 902-566-3133.

ACIC Log#: 32210

Description: Knockout Drum, 80" ID
ASME Stamp, National Board Registered

This space is for Jurisdictional stamp and signature

Newfoundland
Labrador
Service NL

Registered Z4814.20
Date 16 FEB 2022

Engineering and Inspection Services

Registered by: Sttyd

UNDER THE AUTHORITY OF THE
PUBLIC SAFETY ACT AND
THE BOILER, PRESSURE VESSEL AND
COMPRESSED GAS REGULATIONS

ACI Central Inc.

20 McAulay Court, Charlottetown, PE C1A 9M7
P.O. Box 53, Charlottetown, PE C1A 7K1. Phone: 902-566-1975, Fax: 902-566-3133

Recommendation to Register – Pressure Vessel Design

To: Blair Rawlings

Date: 01/24/2022

From: ACI Central Inc.

Manufacturer: Kennedy Fabricating LLC
13436 Kennedy Dr
Splendora, TX 77372
USA

Manufacturer #: PV-9883

Subject: ACI Central Design Review

The product described on this form has satisfied the requirements for review of pressure vessel designs established by the Directors of ACI Central at their September 1994 meeting in Moncton, New Brunswick. We recommend this design be registered in your Jurisdiction under;

CRN: Z4814.2

Unit Description	Drawing Number	Service	Design Code
Knockout Drum	526-01-CRN rev 0	Non Lethal	ASME Sect VIII Div. 1

Shell Side

Tube Side

MAWP @ TEMP	MDMT @ MAWP	MAWP @ TEMP	MDMT @ MAWP
150 PSI @ 450 F	- 20 F @ 150 PSI		

Test Pressure: Hydro: 195 PSI	Pneu:	Test Pressure: Hydro:	Pneu:
-------------------------------	-------	-----------------------	-------

Part	Material	Des. t"	Act. t"	CA"	% EF	RT	PWHT	Dimensions	Notes
Shell	SA 516 70	0.488	0.500	0.125	85	RT3		OD": 80" ID	
Heads	SA 516 70	0.485	0.500	0.125	85			OAL": 284.5"	
Nozzles	SA 106 B							W":	
Flanges	SA 105N							H":	
								HS FT²:	

Notes:

- 1- The return of this form, bearing the signature and stamp of the Jurisdiction will legally establish the CRN shown on this form.
- 2- A copy of the Design bearing the CRN will be sent to the Manufacturer.
- 3- Details including service conditions will be posted on the 'Silent Inspector' Bulletin Board.
- 4- Copies of the Design and Specifications are available to ACIC Members on demand.
- 5- The form will be a permanent ACIC record.
- 6- To reduce turnaround times to a minimum fax your response to 902-566-3133.

ACIC Log#: 32210

Description: Knockout Drum, 80" ID
ASME Stamp, National Board Registered

This space is for Jurisdictional stamp and signature



ACI Central Inc.

20 McAulay Court, Charlottetown, PE C1A 9M7
P.O. Box 53, Charlottetown, PE C1A 7K1. Phone: 902-566-1975, Fax: 902-566-3133

Recommendation to Register – Pressure Vessel Design

To: Matthias Mallman

Date: 01/24/2022

From: ACI Central Inc.

Manufacturer: Kennedy Fabricating LLC
13436 Kennedy Dr
Splendora, TX 77372
USA

Manufacturer #: PV-9883

Subject: ACI Central Design Review

The product described on this form has satisfied the requirements for review of pressure vessel designs established by the Directors of ACI Central at their September 1994 meeting in Moncton, New Brunswick. We recommend this design be registered in your Jurisdiction under;

CRN: Z4814.2

Unit Description	Drawing Number	Service	Design Code
Knockout Drum	526-01-CRN rev 0	Non Lethal	ASME Sect VIII Div. 1

Shell Side

Tube Side

MAWP @ TEMP	MDMT @ MAWP	MAWP @ TEMP	MDMT @ MAWP
150 PSI @ 450 F	- 20 F @ 150 PSI		

Test Pressure: Hydro: 195 PSI	Pneu:	Test Pressure: Hydro:	Pneu:
-------------------------------	-------	-----------------------	-------

Part	Material	Des. t"	Act. t"	CA"	% EF	RT	PWHT	Dimensions	Notes
Shell	SA 516 70	0.488	0.500	0.125	85	RT3		OD": 80" ID	
Heads	SA 516 70	0.485	0.500	0.125	85			OAL": 284.5"	
Nozzles	SA 106 B							W":	
Flanges	SA 105N							H":	
								HS FT":	

Notes:

- 1- The return of this form, bearing the signature and stamp of the Jurisdiction will legally establish the CRN shown on this form.
- 2- A copy of the Design bearing the CRN will be sent to the Manufacturer.
- 3- Details including service conditions will be posted on the 'Silent Inspector' Bulletin Board.
- 4- Copies of the Design and Specifications are available to ACIC Members on demand.
- 5- The form will be a permanent ACIC record.
- 6- To reduce turnaround times to a minimum fax your response to 902-566-3133.

ACIC Log#: 32210

Description: Knockout Drum, 80" ID
ASME Stamp, National Board Registered

This space is for Jurisdictional stamp and signature

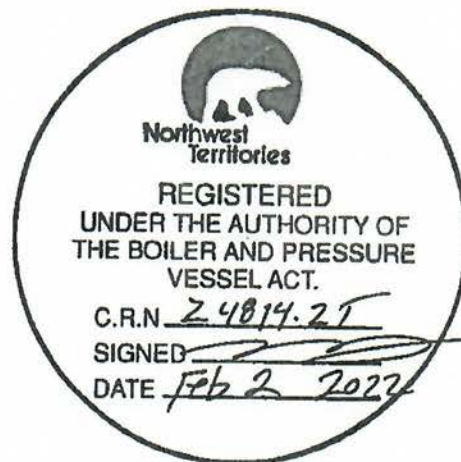

ACI Central Inc.

20 McAulay Court, Charlottetown, PE C1A 9M7
P.O. Box 53, Charlottetown, PE C1A 7K1. Phone: 902-566-1975, Fax: 902-566-3133

Recommendation to Register – Pressure Vessel Design

To: Muhammad Wani

Date: 01/24/2022

From: ACI Central Inc.

Manufacturer: Kennedy Fabricating LLC
13436 Kennedy Dr
Splendora, TX 77372
USA

Manufacturer #: PV-9883

Subject: ACI Central Design Review

The product described on this form has satisfied the requirements for review of pressure vessel designs established by the Directors of ACI Central at their September 1994 meeting in Moncton, New Brunswick. We recommend this design be registered in your Jurisdiction under;

CRN: Z4814.2

Unit Description	Drawing Number	Service	Design Code
Knockout Drum	526-01-CRN rev 0	Non Lethal	ASME Sect VIII Div. 1

Shell Side

Tube Side

MAWP @ TEMP	MDMT @ MAWP	MAWP @ TEMP	MDMT @ MAWP
150 PSI @ 450 F	- 20 F @ 150 PSI		

Test Pressure: Hydro: 195 PSI	Pneu:	Test Pressure: Hydro:	Pneu:
-------------------------------	-------	-----------------------	-------

Part	Material	Des. t"	Act. t"	CA"	% EF	RT	PWHT	Dimensions	Notes
Shell	SA 516 70	0.488	0.500	0.125	85	RT3		OD": 80" ID	
Heads	SA 516 70	0.485	0.500	0.125	85			OAL": 284.5"	
Nozzles	SA 106 B							W":	
Flanges	SA 105N							H":	
								HS FT":	

Notes:

- 1- The return of this form, bearing the signature and stamp of the Jurisdiction will legally establish the CRN shown on this form.
- 2- A copy of the Design bearing the CRN will be sent to the Manufacturer.
- 3- Details including service conditions will be posted on the 'Silent Inspector' Bulletin Board.
- 4- Copies of the Design and Specifications are available to ACIC Members on demand.
- 5- The form will be a permanent ACIC record.
- 6- To reduce turnaround times to a minimum fax your response to 902-566-3133.

ACIC Log#: 32210

Description: Knockout Drum, 80" ID
ASME Stamp, National Board Registered

This space is for Jurisdictional stamp and signature



NUNAVUT

Boilers and
Pressure Vessels Act

REGISTERED

CRN Z4814.2N

Date Jan 28, 2022

Signed _____

Chief Inspector

Territorial Registration Fee

BILL OF MATERIAL									
ITEM	QTY	MARK	DESCRIPTION	MATERIAL	ITEM	QTY	MARK	DESCRIPTION	MATERIAL
100	2	HEADS	80" I.D. x 488" UNL. THK. ASME 2:1 ELLIPTICAL HEAD	SA 516 70	109	2	WELD	5/160 SHORT RADIUS NOT ELBOW (MODIFIED)	SA 516 70
101	1	SHLL	1/2" PLATE 130" x 252" 7/8" (ROLLED TO 80" I.D.)	SA 516 70	110	4	WELD	5/160 PIPE x 25-3/4" LG	SA 516 70
102	1	WV	20" 150# RFLWN x 20" LG	SA 105B	111	1	WELD	1/4" PLATE 2-7/8" x 8"	SA 36
103	4	WV	16" 150# RFLWN 5/160 BORE	SA 105B	112	1	WELD	1/4" PLATE 8" x 8"	SA 36
					113	1	WV	4" 150# BWN 5/160 BORE C/W 150# BLND FLANGE	SA 105B
					114	1	WV	WV NECK 4" 5/160 PIPE x 8" LG	SA 105B
					115	1	WV	WV PAD 1/2" THK. PLATE SHAPED FOR MIN. 2-3/4" PAD WIDTH AROUND 40 OF WV NOZZLE. SEE DETAIL 4.	SA 516 70

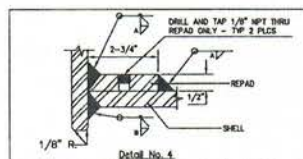
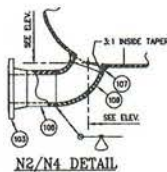
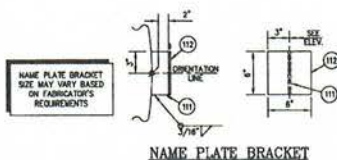
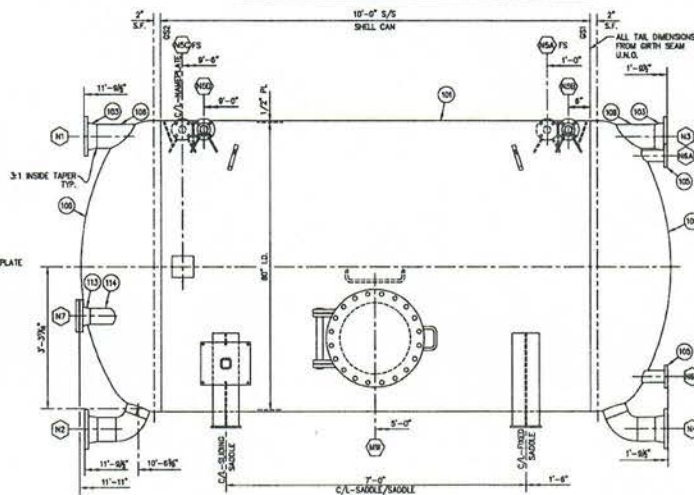
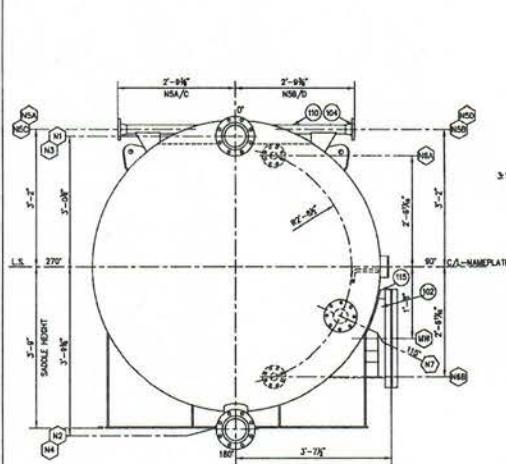

MARK	QTY	SIZE	RATING	TYPE	NECK	WV	THK	BORE	REINP.	PAD	WV	THK	BORE	SERVICE	
WV	1	20"	150#	RFLWN	---	102	---	115	---	1"	---	3/8"	2 1/2"	4	HANDWAY w/ RINGE
N7	1	4"	150#	RFLWN	5/160	113	114	---	---	---	---	1/4"	1 1/4"	1 & 3	WAVEY VALVE
WV	2	4"	150#	RFLWN	---	105	---	---	---	---	---	1/4"	1 1/4"	2	LOCAL BLNDE
WV	4	4"	150#	RFLWN	20-252	104	105	---	---	---	---	1/4"	1 1/4"	1 & 3	VENT
N4	1	8"	150#	RFLWN	20-252	103	104	---	---	---	---	3/8"	---	1 & 3	PROCESS OUTLET/RAIN
N3	1	8"	150#	RFLWN	20-252	103	104	---	---	---	---	3/8"	---	1 & 3	PROCESS INLET
N2	1	8"	150#	RFLWN	20-252	103	104	---	---	---	---	3/8"	---	1 & 3	PROCESS OUTLET/RAIN
N1	1	8"	150#	RFLWN	20-252	103	104	---	---	---	---	3/8"	---	1 & 3	PROCESS INLET

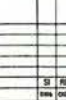
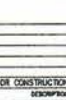

GENERAL NOTES

1. DESIGN

- A. VESSEL DESIGNED IN ACCORDANCE WITH ASME SECTION VIII DIVISION 1, 2019 EDITION
- B. INTERNAL DESIGN PRESSURE: 150 psig @ 450° F
- C. EXTERNAL DESIGN PRESSURE: 15 psig @ 450° F
- D. M.A.P.T.: 20" F @ 150 psig
- E. W.A.P.T.: 150 psig @ 450° F
- F. CORROSION ALLOWANCE: 1/8"
- G. JOINT EFFICIENCY: HEADS 85% SHELL 85%
- H. OPERATING: N/A
- I. LIQUID LEVEL: FULL @ 1 S.G.
- J. WIND CODE: ASCE 7-10
- K. WIND SPEED: 115 MPH
- L. EXPOSURE: C
- M. SEISMIC CODE: AS FOR TRANSPORT

- N. VESSEL IS EXEMPT FROM IMPACT TESTING PER UG-260(a) & UCS-64(b)
- O. ALL TOLERANCES PER ASME SECTION VIII DIVISION 1

2. WEIGHTS

- A. FABRICATED WEIGHT: 8,750 lbs
- B. EXTERNAL PIPING WEIGHT: 3,000 lbs
- C. SHIP WEIGHT: 3,400 lbs
- D. SHIPPING WEIGHT: 15,350 lbs

3. MATERIAL

- A. SHELL/HEADS: SA 516 70
- B. SUPPORTS: SA 36
- C. FLANGES: SA 105B
- D. NOZZLE HEADS: SA 105 B
- E. REINFORCING PADS: N/A
- F. GASKETS: SPIRAL WOUND WITH FLEXIBLE GRAPHITE FILLER, 215 SS, HINDRICKS & RYDER RING AND CS OUTER RING, TYPE COI
- G. EXTERNALS: SA 36/SA 516 70
- H. EXTERNAL BOLTING: SA 193 B7/SA 194 2H 1/2" 7" THREAD EXPOSED MINIMUM

4. NDE

- A. RADIOGRAPHY
- 1. SPOT REPAIRS OF ALL

5. TESTING

- A. NOZZLES SHALL BE HYDRO TESTED WITH SPIRAL WOUND GASKETS
- B. AIR LEAK TEST AFTER PAINT & FULL ASSEMBLY

6. FABRICATION

- A. ALL BOLTS TO BE STRADDLE NORMAL Y'S UNLESS NOTED
- B. PAINT
- 1. SURFACE PREP FOR 100-5PT
- 2. PRIMER COAT SHEEN RELIUS DURA-PLATE 335 4-8 mils DFT
- 3. PRIMER COAT SHEEN RELIUS ADOLEIN 215 10-14 mils DFT
- 4. FINISH COAT SHEEN RELIUS ADOLEIN 215 10-14 mils DFT
- 5. FINISH COAT SHEEN RELIUS ADOLEIN 215 10-14 mils DFT
- 6. FINISH COAT SHEEN RELIUS ADOLEIN 215 10-14 mils DFT
- 7. FINISH COAT SHEEN RELIUS ADOLEIN 215 10-14 mils DFT
- 8. FINISH COAT SHEEN RELIUS ADOLEIN 215 10-14 mils DFT
- 9. FINISH COAT SHEEN RELIUS ADOLEIN 215 10-14 mils DFT
- 10. FINISH COAT SHEEN RELIUS ADOLEIN 215 10-14 mils DFT
- 11. FINISH COAT SHEEN RELIUS ADOLEIN 215 10-14 mils DFT
- 12. FINISH COAT SHEEN RELIUS ADOLEIN 215 10-14 mils DFT
- 13. FINISH COAT SHEEN RELIUS ADOLEIN 215 10-14 mils DFT
- 14. FINISH COAT SHEEN RELIUS ADOLEIN 215 10-14 mils DFT
- 15. FINISH COAT SHEEN RELIUS ADOLEIN 215 10-14 mils DFT
- 16. FINISH COAT SHEEN RELIUS ADOLEIN 215 10-14 mils DFT
- 17. FINISH COAT SHEEN RELIUS ADOLEIN 215 10-14 mils DFT
- 18. FINISH COAT SHEEN RELIUS ADOLEIN 215 10-14 mils DFT
- 19. FINISH COAT SHEEN RELIUS ADOLEIN 215 10-14 mils DFT
- 20. FINISH COAT SHEEN RELIUS ADOLEIN 215 10-14 mils DFT
- 21. FINISH COAT SHEEN RELIUS ADOLEIN 215 10-14 mils DFT
- 22. FINISH COAT SHEEN RELIUS ADOLEIN 215 10-14 mils DFT
- 23. FINISH COAT SHEEN RELIUS ADOLEIN 215 10-14 mils DFT
- 24. FINISH COAT SHEEN RELIUS ADOLEIN 215 10-14 mils DFT
- 25. FINISH COAT SHEEN RELIUS ADOLEIN 215 10-14 mils DFT
- 26. FINISH COAT SHEEN RELIUS ADOLEIN 215 10-14 mils DFT
- 27. FINISH COAT SHEEN RELIUS ADOLEIN 215 10-14 mils DFT
- 28. FINISH COAT SHEEN RELIUS ADOLEIN 215 10-14 mils DFT
- 29. FINISH COAT SHEEN RELIUS ADOLEIN 215 10-14 mils DFT
- 30. FINISH COAT SHEEN RELIUS ADOLEIN 215 10-14 mils DFT
- 31. FINISH COAT SHEEN RELIUS ADOLEIN 215 10-14 mils DFT
- 32. FINISH COAT SHEEN RELIUS ADOLEIN 215 10-14 mils DFT
- 33. FINISH COAT SHEEN RELIUS ADOLEIN 215 10-14 mils DFT
- 34. FINISH COAT SHEEN RELIUS ADOLEIN 215 10-14 mils DFT
- 35. FINISH COAT SHEEN RELIUS ADOLEIN 215 10-14 mils DFT
- 36. FINISH COAT SHEEN RELIUS ADOLEIN 215 10-14 mils DFT
- 37. FINISH COAT SHEEN RELIUS ADOLEIN 215 10-14 mils DFT
- 38. FINISH COAT SHEEN RELIUS ADOLEIN 215 10-14 mils DFT
- 39. FINISH COAT SHEEN RELIUS ADOLEIN 215 10-14 mils DFT
- 40. FINISH COAT SHEEN RELIUS ADOLEIN 215 10-14 mils DFT
- 41. FINISH COAT SHEEN RELIUS ADOLEIN 215 10-14 mils DFT
- 42. FINISH COAT SHEEN RELIUS ADOLEIN 215 10-14 mils DFT
- 43. FINISH COAT SHEEN RELIUS ADOLEIN 215 10-14 mils DFT
- 44. FINISH COAT SHEEN RELIUS ADOLEIN 215 10-14 mils DFT
- 45. FINISH COAT SHEEN RELIUS ADOLEIN 215 10-14 mils DFT
- 46. FINISH COAT SHEEN RELIUS ADOLEIN 215 10-14 mils DFT
- 47. FINISH COAT SHEEN RELIUS ADOLEIN 215 10-14 mils DFT
- 48. FINISH COAT SHEEN RELIUS ADOLEIN 215 10-14 mils DFT
- 49. FINISH COAT SHEEN RELIUS ADOLEIN 215 10-14 mils DFT
- 50. FINISH COAT SHEEN RELIUS ADOLEIN 215 10-14 mils DFT
- 51. FINISH COAT SHEEN RELIUS ADOLEIN 215 10-14 mils DFT
- 52. FINISH COAT SHEEN RELIUS ADOLEIN 215 10-14 mils DFT
- 53. FINISH COAT SHEEN RELIUS ADOLEIN 215 10-14 mils DFT
- 54. FINISH COAT SHEEN RELIUS ADOLEIN 215 10-14 mils DFT
- 55. FINISH COAT SHEEN RELIUS ADOLEIN 215 10-14 mils DFT
- 56. FINISH COAT SHEEN RELIUS ADOLEIN 215 10-14 mils DFT
- 57. FINISH COAT SHEEN RELIUS ADOLEIN 215 10-14 mils DFT
- 58. FINISH COAT SHEEN RELIUS ADOLEIN 215 10-14 mils DFT
- 59. FINISH COAT SHEEN RELIUS ADOLEIN 215 10-14 mils DFT
- 60. FINISH COAT SHEEN RELIUS ADOLEIN 215 10-14 mils DFT
- 61. FINISH COAT SHEEN RELIUS ADOLEIN 215 10-14 mils DFT
- 62. FINISH COAT SHEEN RELIUS ADOLEIN 215 10-14 mils DFT
- 63. FINISH COAT SHEEN RELIUS ADOLEIN 215 10-14 mils DFT
- 64. FINISH COAT SHEEN RELIUS ADOLEIN 215 10-14 mils DFT
- 65. FINISH COAT SHEEN RELIUS ADOLEIN 215 10-14 mils DFT
- 66. FINISH COAT SHEEN RELIUS ADOLEIN 215 10-14 mils DFT
- 67. FINISH COAT SHEEN RELIUS ADOLEIN 215 10-14 mils DFT
- 68. FINISH COAT SHEEN RELIUS ADOLEIN 215 10-14 mils DFT
- 69. FINISH COAT SHEEN RELIUS ADOLEIN 215 10-14 mils DFT
- 70. FINISH COAT SHEEN RELIUS ADOLEIN 215 10-14 mils DFT
- 71. FINISH COAT SHEEN RELIUS ADOLEIN 215 10-14 mils DFT
- 72. FINISH COAT SHEEN RELIUS ADOLEIN 215 10-14 mils DFT
- 73. FINISH COAT SHEEN RELIUS ADOLEIN 215 10-14 mils DFT
- 74. FINISH COAT SHEEN RELIUS ADOLEIN 215 10-14 mils DFT
- 75. FINISH COAT SHEEN RELIUS ADOLEIN 215 10-14 mils DFT
- 76. FINISH COAT SHEEN RELIUS ADOLEIN 215 10-14 mils DFT
- 77. FINISH COAT SHEEN RELIUS ADOLEIN 215 10-14 mils DFT
- 78. FINISH COAT SHEEN RELIUS ADOLEIN 215 10-14 mils DFT
- 79. FINISH COAT SHEEN RELIUS ADOLEIN 215 10-14 mils DFT
- 80. FINISH COAT SHEEN RELIUS ADOLEIN 215 10-14 mils DFT
- 81. FINISH COAT SHEEN RELIUS ADOLEIN 215 10-14 mils DFT
- 82. FINISH COAT SHEEN RELIUS ADOLEIN 215 10-14 mils DFT
- 83. FINISH COAT SHEEN RELIUS ADOLEIN 215 10-14 mils DFT
- 84. FINISH COAT SHEEN RELIUS ADOLEIN 215 10-14 mils DFT
- 85. FINISH COAT SHEEN RELIUS ADOLEIN 215 10-14 mils DFT
- 86. FINISH COAT SHEEN RELIUS ADOLEIN 215 10-14 mils DFT
- 87. FINISH COAT SHEEN RELIUS ADOLEIN 215 10-14 mils DFT
- 88. FINISH COAT SHEEN RELIUS ADOLEIN 215 10-14 mils DFT
- 89. FINISH COAT SHEEN RELIUS ADOLEIN 215 10-14 mils DFT
- 90. FINISH COAT SHEEN RELIUS ADOLEIN 215 10-14 mils DFT
- 91. FINISH COAT SHEEN RELIUS ADOLEIN 215 10-14 mils DFT
- 92. FINISH COAT SHEEN RELIUS ADOLEIN 215 10-14 mils DFT
- 93. FINISH COAT SHEEN RELIUS ADOLEIN 215 10-14 mils DFT
- 94. FINISH COAT SHEEN RELIUS ADOLEIN 215 10-14 mils DFT
- 95. FINISH COAT SHEEN RELIUS ADOLEIN 215 10-14 mils DFT
- 96. FINISH COAT SHEEN RELIUS ADOLEIN 215 10-14 mils DFT
- 97. FINISH COAT SHEEN RELIUS ADOLEIN 215 10-14 mils DFT
- 98. FINISH COAT SHEEN RELIUS ADOLEIN 215 10-14 mils DFT
- 99. FINISH COAT SHEEN RELIUS ADOLEIN 215 10-14 mils DFT
- 100. FINISH COAT SHEEN RELIUS ADOLEIN 215 10-14 mils DFT

- C. ALL COMPONENTS SHALL BE PAINTED IMMEDIATELY

7. SHIPPING

- A. VESSEL SHALL BE THOROUGHLY CLEANED AND DRIED
- B. VESSEL SHALL BE THOROUGHLY CLEANED AND DRIED
- C. VESSEL SHALL BE THOROUGHLY CLEANED AND DRIED
- D. VESSEL SHALL BE THOROUGHLY CLEANED AND DRIED
- E. VESSEL SHALL BE THOROUGHLY CLEANED AND DRIED
- F. VESSEL SHALL BE THOROUGHLY CLEANED AND DRIED
- G. VESSEL SHALL BE THOROUGHLY CLEANED AND DRIED
- H. VESSEL SHALL BE THOROUGHLY CLEANED AND DRIED
- I. VESSEL SHALL BE THOROUGHLY CLEANED AND DRIED
- J. VESSEL SHALL BE THOROUGHLY CLEANED AND DRIED
- K. VESSEL SHALL BE THOROUGHLY CLEANED AND DRIED
- L. VESSEL SHALL BE THOROUGHLY CLEANED AND DRIED
- M. VESSEL SHALL BE THOROUGHLY CLEANED AND DRIED
- N. VESSEL SHALL BE THOROUGHLY CLEANED AND DRIED
- O. VESSEL SHALL BE THOROUGHLY CLEANED AND DRIED
- P. VESSEL SHALL BE THOROUGHLY CLEANED AND DRIED
- Q. VESSEL SHALL BE THOROUGHLY CLEANED AND DRIED
- R. VESSEL SHALL BE THOROUGHLY CLEANED AND DRIED
- S. VESSEL SHALL BE THOROUGHLY CLEANED AND DRIED
- T. VESSEL SHALL BE THOROUGHLY CLEANED AND DRIED
- U. VESSEL SHALL BE THOROUGHLY CLEANED AND DRIED
- V. VESSEL SHALL BE THOROUGHLY CLEANED AND DRIED
- W. VESSEL SHALL BE THOROUGHLY CLEANED AND DRIED
- X. VESSEL SHALL BE THOROUGHLY CLEANED AND DRIED
- Y. VESSEL SHALL BE THOROUGHLY CLEANED AND DRIED
- Z. VESSEL SHALL BE THOROUGHLY CLEANED AND DRIED
- AA. VESSEL SHALL BE THOROUGHLY CLEANED AND DRIED
- AB. VESSEL SHALL BE THOROUGHLY CLEANED AND DRIED
- AC. VESSEL SHALL BE THOROUGHLY CLEANED AND DRIED
- AD. VESSEL SHALL BE THOROUGHLY CLEANED AND DRIED
- AE. VESSEL SHALL BE THOROUGHLY CLEANED AND DRIED
- AF. VESSEL SHALL BE THOROUGHLY CLEANED AND DRIED
- AG. VESSEL SHALL BE THOROUGHLY CLEANED AND DRIED
- AH. VESSEL SHALL BE THOROUGHLY CLEANED AND DRIED
- AI. VESSEL SHALL BE THOROUGHLY CLEANED AND DRIED
- AJ. VESSEL SHALL BE THOROUGHLY CLEANED AND DRIED
- AK. VESSEL SHALL BE THOROUGHLY CLEANED AND DRIED
- AL. VESSEL SHALL BE THOROUGHLY CLEANED AND DRIED
- AM. VESSEL SHALL BE THOROUGHLY CLEANED AND DRIED
- AN. VESSEL SHALL BE THOROUGHLY CLEANED AND DRIED
- AO. VESSEL SHALL BE THOROUGHLY CLEANED AND DRIED
- AP. VESSEL SHALL BE THOROUGHLY CLEANED AND DRIED
- AQ. VESSEL SHALL BE THOROUGHLY CLEANED AND DRIED
- AR. VESSEL SHALL BE THOROUGHLY CLEANED AND DRIED
- AS. VESSEL SHALL BE THOROUGHLY CLEANED AND DRIED
- AT. VESSEL SHALL BE THOROUGHLY CLEANED AND DRIED
- AU. VESSEL SHALL BE THOROUGHLY CLEANED AND DRIED
- AV. VESSEL SHALL BE THOROUGHLY CLEANED AND DRIED
- AW. VESSEL SHALL BE THOROUGHLY CLEANED AND DRIED
- AX. VESSEL SHALL BE THOROUGHLY CLEANED AND DRIED
- AY. VESSEL SHALL BE THOROUGHLY CLEANED AND DRIED
- AZ. VESSEL SHALL BE THOROUGHLY CLEANED AND DRIED
- BA. VESSEL SHALL BE THOROUGHLY CLEANED AND DRIED
- BB. VESSEL SHALL BE THOROUGHLY CLEANED AND DRIED
- BC. VESSEL SHALL BE THOROUGHLY CLEANED AND DRIED
- BD. VESSEL SHALL BE THOROUGHLY CLEANED AND DRIED
- BE. VESSEL SHALL BE THOROUGHLY CLEANED AND DRIED
- BF. VESSEL SHALL BE THOROUGHLY CLEANED AND DRIED
- BG. VESSEL SHALL BE THOROUGHLY CLEANED AND DRIED
- BH. VESSEL SHALL BE THOROUGHLY CLEANED AND DRIED
- BI. VESSEL SHALL BE THOROUGHLY CLEANED AND DRIED
- BJ. VESSEL SHALL BE THOROUGHLY CLEANED AND DRIED
- BK. VESSEL SHALL BE THOROUGHLY CLEANED AND DRIED
- BL. VESSEL SHALL BE THOROUGHLY CLEANED AND DRIED
- BM. VESSEL SHALL BE THOROUGHLY CLEANED AND DRIED
- BN. VESSEL SHALL BE THOROUGHLY CLEANED AND DRIED
- BO. VESSEL SHALL BE THOROUGHLY CLEANED AND DRIED
- BP. VESSEL SHALL BE THOROUGHLY CLEANED AND DRIED
- BQ. VESSEL SHALL BE THOROUGHLY CLEANED AND DRIED
- BR. VESSEL SHALL BE THOROUGHLY CLEANED AND DRIED
- BS. VESSEL SHALL BE THOROUGHLY CLEANED AND DRIED
- BT. VESSEL SHALL BE THOROUGHLY CLEANED AND DRIED
- BU. VESSEL SHALL BE THOROUGHLY CLEANED AND DRIED
- BV. VESSEL SHALL BE THOROUGHLY CLEANED AND DRIED
- BW. VESSEL SHALL BE THOROUGHLY CLEANED AND DRIED
- BX. VESSEL SHALL BE THOROUGHLY CLEANED AND DRIED
- BY. VESSEL SHALL BE THOROUGHLY CLEANED AND DRIED
- BZ. VESSEL SHALL BE THOROUGHLY CLEANED AND DRIED
- CA. VESSEL SHALL BE THOROUGHLY CLEANED AND DRIED
- CB. VESSEL SHALL BE THOROUGHLY CLEANED AND DRIED
- CC. VESSEL SHALL BE THOROUGHLY CLEANED AND DRIED
- CD. VESSEL SHALL BE THOROUGHLY CLEANED AND DRIED
- CE. VESSEL SHALL BE THOROUGHLY CLEANED AND DRIED
- CF. VESSEL SHALL BE THOROUGHLY CLEANED AND DRIED
- CG. VESSEL SHALL BE THOROUGHLY CLEANED AND DRIED
- CH. VESSEL SHALL BE THOROUGHLY CLEANED AND DRIED
- CI. VESSEL SHALL BE THOROUGHLY CLEANED AND DRIED
- CJ. VESSEL SHALL BE THOROUGHLY CLEANED AND DRIED
- CK. VESSEL SHALL BE THOROUGHLY CLEANED AND DRIED
- CL. VESSEL SHALL BE THOROUGHLY CLEANED AND DRIED
- CM. VESSEL SHALL BE THOROUGHLY CLEANED AND DRIED
- CN. VESSEL SHALL BE THOROUGHLY CLEANED AND DRIED
- CO. VESSEL SHALL BE THOROUGHLY CLEANED AND DRIED
- CP. VESSEL SHALL BE THOROUGHLY CLEANED AND DRIED
- CQ. VESSEL SHALL BE THOROUGHLY CLEANED AND DRIED
- CR. VESSEL SHALL BE THOROUGHLY CLEANED AND DRIED
- CS. VESSEL SHALL BE THOROUGHLY CLEANED AND DRIED
- CT. VESSEL SHALL BE THOROUGHLY CLEANED AND DRIED
- CU. VESSEL SHALL BE THOROUGHLY CLEANED AND DRIED
- CV. VESSEL SHALL BE THOROUGHLY CLEANED AND DRIED
- CW. VESSEL SHALL BE THOROUGHLY CLEANED AND DRIED
- CX. VESSEL SHALL BE THOROUGHLY CLEANED AND DRIED
- CY. VESSEL SHALL BE THOROUGHLY CLEANED AND DRIED
- CZ. VESSEL SHALL BE THOROUGHLY CLEANED AND DRIED
- DA. VESSEL SHALL BE THOROUGHLY CLEANED AND DRIED
- DB. VESSEL SHALL BE THOROUGHLY CLEANED AND DRIED
- DC. VESSEL SHALL BE THOROUGHLY CLEANED AND DRIED
- DD. VESSEL SHALL BE THOROUGHLY CLEANED AND DRIED
- DE. VESSEL SHALL BE THOROUGHLY CLEANED AND DRIED
- DF. VESSEL SHALL BE THOROUGHLY CLEANED AND DRIED
- DG. VESSEL SHALL BE THOROUGHLY CLEANED AND DRIED
- DH. VESSEL SHALL BE THOROUGHLY CLEANED AND DRIED
- DI. VESSEL SHALL BE THOROUGHLY CLEANED AND DRIED
- DJ. VESSEL SHALL BE THOROUGHLY CLEANED AND DRIED
- DK. VESSEL SHALL BE THOROUGHLY CLEANED AND DRIED
- DL. VESSEL SHALL BE THOROUGHLY CLEANED AND DRIED
- DM. VESSEL SHALL BE THOROUGHLY CLEANED AND DRIED
- DN. VESSEL SHALL BE THOROUGHLY CLEANED AND DRIED
- DO. VESSEL SHALL BE THOROUGHLY CLEANED AND DRIED
- DP. VESSEL SHALL BE THOROUGHLY CLEANED AND DRIED
- DQ. VESSEL SHALL BE THOROUGHLY CLEANED AND DRIED
- DR. VESSEL SHALL BE THOROUGHLY CLEANED AND DRIED
- DS. VESSEL SHALL BE THOROUGHLY CLEANED AND DRIED
- DT. VESSEL SHALL BE THOROUGHLY CLEANED AND DRIED
- DU. VESSEL SHALL BE THOROUGHLY CLEANED AND DRIED
- DV. VESSEL SHALL BE THOROUGHLY CLEANED AND DRIED
- DW. VESSEL SHALL BE THOROUGHLY CLEANED AND DRIED
- DX. VESSEL SHALL BE THOROUGHLY CLEANED AND DRIED
- DY. VESSEL SHALL BE THOROUGHLY CLEANED AND DRIED
- DZ. VESSEL SHALL BE THOROUGHLY CLEANED AND DRIED
- EA. VESSEL SHALL BE THOROUGHLY CLEANED AND DRIED
- EB. VESSEL SHALL BE THOROUGHLY CLEANED AND DRIED
- EC. VESSEL SHALL BE THOROUGHLY CLEANED AND DRIED
- ED. VESSEL SHALL BE THOROUGHLY CLEANED AND DRIED
- EE. VESSEL SHALL BE THOROUGHLY CLEANED AND DRIED
- EF. VESSEL SHALL BE THOROUGHLY CLEANED AND DRIED
- EG. VESSEL SHALL BE THOROUGHLY CLEANED AND DRIED
- EH. VESSEL SHALL BE THOROUGHLY CLEANED AND DRIED
- EI. VESSEL SHALL BE THOROUGHLY CLEANED AND DRIED
- EJ. VESSEL SHALL BE THOROUGHLY CLEANED AND DRIED
- EK. VESSEL SHALL BE THOROUGHLY CLEANED AND DRIED
- EL. VESSEL SHALL BE THOROUGHLY CLEANED AND DRIED
- EM. VESSEL SHALL BE THOROUGHLY CLEANED AND DRIED
- EN. VESSEL SHALL BE THOROUGHLY CLEANED AND DRIED
- EO. VESSEL SHALL BE THOROUGHLY CLEANED AND DRIED
- EP. VESSEL SHALL BE THOROUGHLY CLEANED AND DRIED
- EQ. VESSEL SHALL BE THOROUGHLY CLEANED AND DRIED
- ER. VESSEL SHALL BE THOROUGHLY CLEANED AND DRIED
- ES. VESSEL SHALL BE THOROUGHLY CLEANED AND DRIED
- ET. VESSEL SHALL BE THOROUGHLY CLEANED AND DRIED
- EU. VESSEL SHALL BE THOROUGHLY CLEANED AND DRIED
- EV. VESSEL SHALL BE THOROUGHLY CLEANED AND DRIED
- EW. VESSEL SHALL BE THOROUGHLY CLEANED AND DRIED
- EX. VESSEL SHALL BE THOROUGHLY CLEANED AND DRIED
- EY. VESSEL SHALL BE THOROUGHLY CLEANED AND DRIED
- EZ. VESSEL SHALL BE THOROUGHLY CLEANED AND DRIED
- FA. VESSEL SHALL BE THOROUGHLY CLEANED AND DRIED
- FB. VESSEL SHALL BE THOROUGHLY CLEANED AND DRIED
- FC. VESSEL SHALL BE THOROUGHLY CLEANED AND DRIED
- FD. VESSEL SHALL BE THOROUGHLY CLEANED AND DRIED
- FE. VESSEL SHALL BE THOROUGHLY CLEANED AND DRIED
- FF. VESSEL SHALL BE THOROUGHLY CLEANED AND DRIED
- FG. VESSEL SHALL BE THOROUGHLY CLEANED AND DRIED
- FH. VESSEL SHALL BE THOROUGHLY CLEANED AND DRIED
- FI. VESSEL SHALL BE THOROUGHLY CLEANED AND DRIED
- FJ. VESSEL SHALL BE THOROUGHLY CLEANED AND DRIED
- FK. VESSEL SHALL BE THOROUGHLY CLEANED AND DRIED
- FL. VESSEL SHALL BE THOROUGHLY CLEANED AND DRIED
- FM. VESSEL SHALL BE THOROUGHLY CLEANED AND DRIED
- FN. VESSEL SHALL BE THOROUGHLY CLEANED AND DRIED
- FO. VESSEL SHALL BE THOROUGHLY CLEANED AND DRIED
- FP. VESSEL SHALL BE THOROUGHLY CLEANED AND DRIED
- FQ. VESSEL SHALL BE THOROUGHLY CLEANED AND DRIED
- FR. VESSEL SHALL BE THOROUGHLY CLEANED AND DRIED
- FS. VESSEL SHALL BE THOROUGHLY CLEANED AND DRIED
- FT. VESSEL SHALL BE THOROUGHLY CLEANED AND DRIED
- FU. VESSEL SHALL BE THOROUGHLY CLEANED AND DRIED
- FV. VESSEL SHALL BE THOROUGHLY CLEANED AND DRIED
- FW. VESSEL SHALL BE THOROUGHLY CLEANED AND DRIED
- FX. VESSEL SHALL BE THOROUGHLY CLEANED AND DRIED
- FY. VESSEL SHALL BE THOROUGHLY CLEANED AND DRIED
- FZ. VESSEL SHALL BE THOROUGHLY CLEANED AND DRIED
- GA. VESSEL SHALL BE THOROUGHLY CLEANED AND DRIED
- GB. VESSEL SHALL BE THOROUGHLY CLEANED AND DRIED
- GC. VESSEL SHALL BE THOROUGHLY CLEANED AND DRIED
- GD. VESSEL SHALL BE THOROUGHLY CLEANED AND DRIED
- GE. VESSEL SHALL BE THOROUGHLY CLEANED AND DRIED
- GF. VESSEL SHALL BE THOROUGHLY CLEANED AND DRIED
- GG. VESSEL SHALL BE THOROUGHLY CLEANED AND DRIED
- GH. VESSEL SHALL BE THOROUGHLY CLEANED AND DRIED
- GI. VESSEL SHALL BE THOROUGHLY CLEANED AND DRIED
- GJ. VESSEL SHALL BE THOROUGHLY CLEANED AND DRIED
- GK. VESSEL SHALL BE THOROUGHLY CLEANED AND DRIED
- GL. VESSEL SHALL BE THOROUGHLY CLEANED AND DRIED
- GM. VESSEL SHALL BE THOROUGHLY CLEANED AND DRIED
- GN. VESSEL SHALL BE THOROUGHLY CLEANED AND DRIED
- GO. VESSEL SHALL BE THOROUGHLY CLEANED AND DRIED
- GP. VESSEL SHALL BE THOROUGHLY CLEANED AND DRIED
- GQ. VESSEL SHALL BE THOROUGHLY CLEANED AND DRIED
- GR. VESSEL SHALL BE THOROUGHLY CLEANED AND DRIED
- GS. VESSEL SHALL BE THOROUGHLY CLEANED AND DRIED
- GT. VESSEL SHALL BE THOROUGHLY CLEANED AND DRIED
- GU. VESSEL SHALL BE THOROUGHLY CLEANED AND DRIED
- GV. VESSEL SHALL BE THOROUGHLY CLEANED AND DRIED
- GW. VESSEL SHALL BE THOROUGHLY CLEANED AND DRIED
- GX. VESSEL SHALL BE THOROUGHLY CLEANED AND DRIED
- GY. VESSEL SHALL BE THOROUGHLY CLEANED AND DRIED
- GZ. VESSEL SHALL BE THOROUGHLY CLEANED AND DRIED
- HA. VESSEL SHALL BE THOROUGHLY CLEANED AND DRIED
- HB. VESSEL SHALL BE THOROUGHLY CLEANED AND DRIED
- HC. VESSEL SHALL BE THOROUGHLY CLEANED AND DRIED
- HD. VESSEL SHALL BE THOROUGHLY CLEANED AND DRIED
- HE. VESSEL SHALL BE THOROUGHLY CLEANED AND DRIED
- HF. VESSEL SHALL BE THOROUGHLY CLEANED AND DRIED
- HG. VESSEL SHALL BE THOROUGHLY CLEANED AND DRIED
- HI. VESSEL SHALL BE THOROUGHLY CLEANED AND DRIED
- HJ. VESSEL SHALL BE THOROUGHLY CLEANED AND DRIED
- HK. VESSEL SHALL BE THOROUGHLY CLEANED AND DRIED
- HL. VESSEL SHALL BE THOROUGHLY CLEANED AND DRIED
- HM. VESSEL SHALL BE THOROUGHLY CLEANED AND DRIED
- HN. VESSEL SHALL BE THOROUGHLY CLEANED AND DRIED
- HO. VESSEL SHALL BE THOROUGHLY CLEANED AND DRIED
- HP. VESSEL SHALL BE THOROUGHLY CLEANED AND DRIED
- HQ. VESSEL SHALL BE THOROUGHLY CLEANED AND DRIED
- HR. VESSEL SHALL BE THOROUGHLY CLEANED AND DRIED
- HS. VESSEL SHALL BE THOROUGHLY CLEANED AND DRIED
- HT. VESSEL SHALL BE THOROUGHLY CLEANED AND DRIED
- HU. VESSEL SHALL BE THOROUGHLY CLEANED AND DRIED
- HV. VESSEL SHALL BE THOROUGHLY CLEANED AND DRIED
- HW. VESSEL SHALL BE THOROUGHLY CLEANED AND DRIED
- HX. VESSEL SHALL BE THOROUGHLY CLEANED AND DRIED
- HY. VESSEL SHALL BE THOROUGHLY CLEANED AND DRIED
- HZ. VESSEL SHALL BE THOROUGHLY CLEANED AND DRIED
- IA. VESSEL SHALL BE THOROUGHLY CLEANED AND DRIED
- IB. VESSEL SHALL BE THOROUGHLY CLEANED AND DRIED
- IC. VESSEL SHALL BE THOROUGHLY CLEANED AND DRIED
- ID. VESSEL SHALL BE THOROUGHLY CLEANED AND DRIED
- IE. VESSEL SHALL BE THOROUGHLY CLEANED AND DRIED
- IF. VESSEL SHALL BE THOROUGHLY CLEANED AND DRIED
- IG. VESSEL SHALL BE THOROUGHLY CLEANED AND DRIED
- IH. VESSEL SHALL BE THOROUGHLY CLEANED AND DRIED
- II. VESSEL SHALL BE THOROUGHLY CLEANED AND DRIED
- IJ. VESSEL SHALL BE THOROUGHLY CLEANED AND DRIED
- IK. VESSEL SHALL BE THOROUGHLY CLEANED AND DRIED
- IL. VESSEL SHALL BE THOROUGHLY CLEANED AND DRIED
- IM. VESSEL SHALL BE THOROUGHLY CLEANED AND DRIED
- IN. VESSEL SHALL BE THOROUGHLY CLEANED AND DRIED
- IO. VESSEL SHALL BE THOROUGHLY CLEANED AND DRIED
- IP. VESSEL SHALL BE THOROUGHLY CLEANED AND DRIED
- IQ. VESSEL SHALL BE THOROUGHLY CLEANED AND DRIED
- IR. VESSEL SHALL BE THOROUGHLY CLEANED AND DRIED
- IS. VESSEL SHALL BE THOROUGHLY CLEANED AND DRIED
- IT. VESSEL SHALL BE THOROUGHLY CLEANED AND DRIED
- IU. VESSEL SHALL BE THOROUGHLY CLEANED AND DRIED
- IV. VESSEL SHALL BE THOROUGHLY CLEANED AND DRIED
- IW. VESSEL SHALL BE THOROUGHLY CLEANED AND DRIED
- IX. VESSEL SHALL BE THOROUGHLY CLEANED AND DRIED
- IY. VESSEL SHALL BE THOROUGHLY CLEANED AND DRIED
- IZ. VESSEL SHALL BE THOROUGHLY CLEANED AND DRIED
- JA. VESSEL SHALL BE THOROUGHLY CLEANED AND DRIED
- JB. VESSEL SHALL BE THOROUGHLY CLEANED AND DRIED
- JC. VESSEL SHALL BE THOROUGHLY CLEANED AND DRIED
- JD. VESSEL SHALL BE THOROUGHLY CLEANED AND DRIED
- JE. VESSEL SHALL BE THOROUGHLY CLEANED AND DRIED
- JF. VESSEL SHALL BE THOROUGHLY CLEANED AND DRIED
- JG. VESSEL SHALL BE THOROUGHLY CLEANED AND DRIED
- JH. VESSEL SHALL BE THOROUGHLY CLEANED AND DRIED
- JI. VESSEL SHALL BE THOROUGHLY CLEANED AND DRIED
- JJ. VESSEL SHALL BE THOROUGHLY CLEANED AND DRIED
- JK. VESSEL SHALL BE THOROUGHLY CLEANED AND DRIED
- JL. VESSEL SHALL BE THOROUGHLY CLEANED AND DRIED
- JM. VESSEL SHALL BE THOROUGHLY CLEANED AND DRIED
- JN. VESSEL SHALL BE THOROUGHLY CLEANED AND DRIED
- JO. VESSEL SHALL BE THOROUGHLY CLEANED AND DRIED
- JP. VESSEL SHALL BE THOROUGHLY CLEANED AND DRIED
- JQ. VESSEL SHALL BE THOROUGHLY CLEANED AND DRIED
- JR. VESSEL SHALL BE THOROUGHLY CLEANED AND DRIED
- JS. VESSEL SHALL BE THOROUGHLY CLEANED AND DRIED
- JT. VESSEL SHALL BE THOROUGHLY CLEANED AND DRIED
- JU. VESSEL SHALL BE THOROUGHLY CLEANED AND DRIED
- JV. VESSEL SHALL BE THOROUGHLY CLEANED AND DRIED
- JW. VESSEL SHALL BE THOROUGHLY CLEANED AND DRIED
- JX. VESSEL SHALL BE THOROUGHLY CLEANED AND DRIED
- JY. VESSEL SHALL BE THOROUGHLY CLEANED AND DRIED
- JZ. VESSEL SHALL BE THOROUGHLY CLEANED AND DRIED
- KA. VESSEL SHALL BE THOROUGHLY CLEANED AND DRIED
- KB. VESSEL SHALL BE THOROUGHLY CLEANED AND DRIED
- KC. VESSEL SHALL BE THOROUGHLY CLEANED AND DRIED
- KD. VESSEL SHALL BE THOROUGHLY CLEANED AND DRIED
- KE. VESSEL SHALL BE THOROUGHLY CLEANED AND DRIED
- KF. VESSEL SHALL BE THOROUGHLY CLEANED AND DRIED
- KG. VESSEL SHALL BE THOROUGHLY CLEANED AND DRIED
- KH. VESSEL SHALL BE THOROUGHLY CLEANED AND DRIED
- KI. VESSEL SHALL BE THOROUGHLY CLEANED AND DRIED
- KJ. VESSEL SHALL BE THOROUGHLY CLEANED AND DRIED
- KL. VESSEL SHALL BE THOROUGHLY CLEANED AND DRIED
- KM. VESSEL SHALL BE THOROUGHLY CLEANED AND DRIED
- KN. VESSEL SHALL BE THOROUGHLY CLEANED AND DRIED
- KO. VESSEL SHALL BE THOROUGHLY CLEANED AND DRIED
- KP. VESSEL SHALL BE THOROUGHLY CLEANED AND DRIED
- KQ. VESSEL SHALL BE THOROUGHLY CLEANED AND DRIED
- KR. VESSEL SHALL BE THOROUGHLY CLEANED AND DRIED
- KS. VESSEL SHALL BE THOROUGHLY CLEANED AND DRIED
- KT. VESSEL SHALL BE THOROUGHLY CLEANED AND DRIED
- KU. VESSEL SHALL BE THOROUGHLY CLEANED AND DRIED
- KV. VESSEL SHALL BE THOROUGHLY CLEANED AND DRIED
- KW. VESSEL SHALL BE THOROUGHLY CLEANED AND DRIED
- KX. VESSEL SHALL BE THOROUGHLY CLEANED AND DRIED
- KY. VESSEL SHALL BE THOROUGHLY CLEANED AND DRIED
- KZ. VESSEL SHALL BE THOROUGHLY CLEANED AND DRIED
- LA. VESSEL SHALL BE THOROUGHLY CLEANED AND DRIED
- LB. VESSEL SHALL BE THOROUGHLY CLEANED AND DRIED
- LC. VESSEL SHALL BE THOROUGHLY CLEANED AND DRIED
- LD. VESSEL SHALL BE THOROUGHLY CLEANED AND DRIED
- LE. VESSEL SHALL BE THOROUGHLY CLEANED AND DRIED
- LF. VESSEL SHALL BE THOROUGHLY CLEANED AND DRIED
- LG. VESSEL SHALL BE THOROUGHLY CLEANED AND DRIED
- LH. VESSEL SHALL BE THOROUGHLY CLEANED AND DRIED
- LI. VESSEL SHALL BE THOROUGHLY CLEANED AND DRIED
- L